

## CMP

## Monobloc without outdoor unit

Cooling capacity 2,33 kW  
Heating capacity 2,31 kW



- Two holes, no outdoor units.
- Modern design to blend with all furnishing styles.
- Extremely thin, with a depth of just 165 mm.



### DESCRIPTION

The air-conditioners of the CMP range are of the single-block type and are ideal for heating, cooling, dehumidification or ventilation only, whether in the home or the office.

The absence of an outdoor unit permits installation in all those cases where architectural restraints prevent the positioning of a split air-conditioner. The unit boasts a compressor and a fan with inverter technology.

### FEATURES

#### Unit

Indoor unit designed for installation on internal walls.

- No need for an outdoor unit just make two 162 mm holes in the outer wall so the air-conditioner can exchange heat with the external environment.
- Folding grilles included.
- On-board control panel with display and soft-touch keys.
- Included remote control.

Cooling operation with outside temperatures up to 43 °C.

Heating operation with outdoor temperatures down to -15 °C.



### Folding grilles

With two folding grilles which, activated by the inlet and outlet air, open when the machine is working and close when the machine is switched off. In this way they guarantee enhanced indoor comfort, less dust, noise and pollution, reduced maintenance and are even less visible from the outside.

### Control panel

The on-board control panel with display and soft-touch keys allows you to set the required temperature set-point easily and accurately.

The "heating" function is deactivated by a simple intervention on the control panel: the device then works in "cooling only" mode, without requiring the condensate discharge tube.

The air delivery fin is easily orientated by means of the relative key.

### Remote control

Handy remote control that's not too bulky.

Fitted with a practical magnet so it can be fixed to the unit.

All the control panel functions are available via the remote control too.

### GENERAL FEATURES

- Condensate drip tray constantly pre-heated in the winter during heat pump operation, without any risk of the water freezing.
- Operating mode: cooling, dehumidification and fan only.
- Particularly quiet operation.
- Microprocessor control.

### ACCESSORIES AS STANDARD

- Condensate drip.
- Two folding grilles.
- Remote control.

## PERFORMANCE SPECIFICATIONS

CMP23G		
<b>Nominal cooling performances</b>		
Cooling capacity	kW	2,33
Moisture removed	l/h	0,9
Cooling input power	kW	0,72
EER	W/W	3,25
<b>Maximum cooling performances</b>		
Cooling capacity	kW	3,10
<b>Minimum cooling performances</b>		
Cooling capacity	kW	0,92
<b>Seasonal efficiency</b>		
Efficiency energy class		A+
<b>Nominal heating performances</b>		
Heating capacity	kW	2,31
Heating input power	kW	0,71
COP	W/W	3,28
<b>Maximum heating performances</b>		
Heating capacity	kW	3,05
<b>Minimum heating performances</b>		
Heating capacity	kW	0,79
<b>Seasonal efficiency (temperate climate)</b>		
Efficiency energy class		A

Outdoor air temperature 35 °, relative humidity 41%. Ambient temperature 27 °C; relative humidity 47%. Performance according to EN 14511  
 Energy Efficiency according to Directive 626/2011- Valid for tax deduction  
 Fresh air temperature 7 °C, relative humidity 87%. Room temperature 20°C, relative humidity 59% (max). Performance according to UNI 14511

## GENERAL DATA

CMP23G		
<b>Aeraulic data indoor</b>		
Fan speed	Nr.	3+2
Maximum air flow rate	m³/h	400
Medium air flow	m³/h	320
Minimum air flow rate	m³/h	270
<b>Aeraulic data outdoor</b>		
Fan speed	Nr.	3
Maximum air flow rate	m³/h	480
Medium air flow	m³/h	340
Minimum air flow rate	m³/h	390
<b>Electric data</b>		
Input power	kW	-
Maximum absorbed current	A	4,60
Voltage	V/ph/Hz	230/1/50
<b>Sound data</b>		
Nominal sound pressure	dB(A)	41
Minimum sound pressure	dB(A)	27
<b>Compressor</b>		
Refrigerant	type	R32
Refrigerant charge (1)	kg	0,5
Type	type	Rotary DC inverter

(1) The load indicated in the table is an estimated and preliminary value. The final value of the refrigerant load is indicated on the unit's technical label. For further information contact the office.  
 Efficiency according to UNI EN 13141-7 Indoor temperature 20 °C - Indoor humidity 28 % - Outdoor temperature 7 °C - Outdoor humidity 72 %.

3 manual speed + auto speed + boost speed

Internal side sound pressure measured in semi-anechoic chamber at a distance of 2 m according to ISO 7779

DIMENSIONS AND WEIGHTS

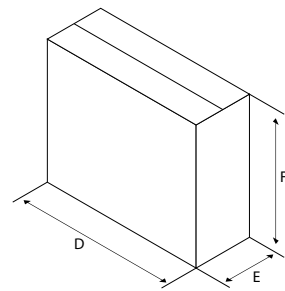
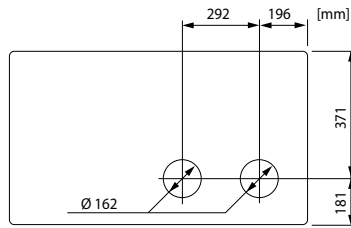
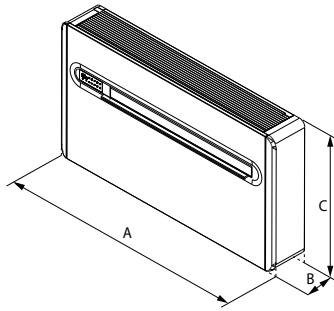

CMP23G		
Dimensions and weights		
A	mm	1010
B	mm	165
C	mm	549
D	mm	1100
E	mm	255
F	mm	670
Net weight	kg	41,0
Weight for transport	kg	45,0

Aermec reserves the right to make any modifications deemed necessary.  
All data is subject to change without notice. Aermec does not assume  
responsibility or liability for errors or omissions.

**Aermec S.p.A.**  
Via Roma, 996 - 37040 Bevilacqua (VR) - Italia  
Tel. 0442633111 - Telefax 044293577  
[www.aermec.com](http://www.aermec.com)



A series of horizontal dotted lines spanning the width of the page, providing a guide for handwriting practice.